

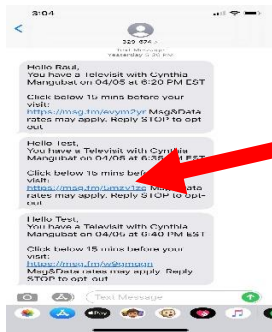

## TELEVISIT INSTRUCTION

The simplest way to access televisit is thru **mobile phone**.

- a) Patient will receive a text message confirming the appointment. Then **click the link**.



- b) Answer vitals then submit. c) Start the televisit

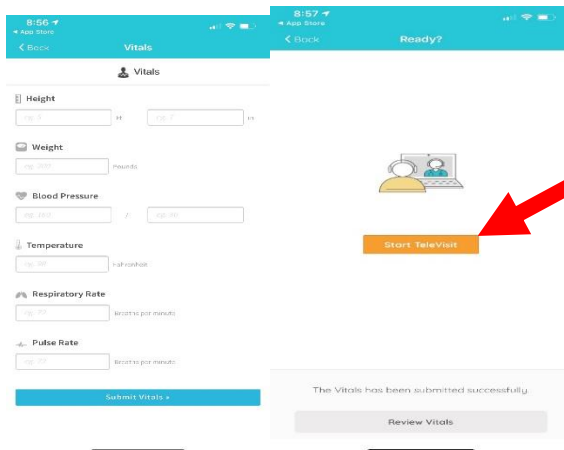

JUST LIKE A PATIENT GOING IN TO THE OFFICE, **PATIENT NEEDS TO START THE TELEVISIT**. Please wait until the doctor joins in.

We will bill the insurance for this televisit.

Please confirm your email address and cellphone number.